

- 01 Hughes Education Center  
(Check-In & West side entrance)
- 02 Iowa Hosta Garden
- 03 Stout Silver Medal Winner  
Daylily Garden
- 04 Original Conifer Collection
- 05 Perennial Garden
- 06 Shrub Border
- 07 Theresa Schutt Hosta House
- 08 Cafferty Building
- 09 Dale Seims Greenhouse
- 10 Hosta Border
- 11 Beckwith Grand Pavilion
- 12 Waterside Garden
- 13 Jacobsen Conifer Garden

- 14 Alpine Garden
- 15 Jones Memorial Gazebo
- 16 Butterfly Garden
- 17 Prairie Strip
- 18 Children's Garden
- 19 Orchard and Herb Garden
- 20 Palustrine Wetland
- 21 Iris and Daylily Garden
- 22 Beehive boxes
- 23 Flowering Tree Grove
- 24 Windbreak
- 25 Wetland Tree Grove
- 26 Deciduous Windbreak
- 27 Nut Tree Grove
- 28 Bluestem

# IOWA ARBORETUM & Gardens

1875 Peach Avenue  
Madrid, IA 50156

- 29 Arie Kroeze Memorial Tea House
- 30 Tea House Garden
- 31 Great Lawn
- 32 Trial Garden
- 33 Founder's Grove
- 34 Governor's Oak Grove
- 35 Coffman Viburnum Walk
- 36 Dry Creek Bed

## Adele & Dean Bowden Treehouse Village

Enjoy a collection of treehouses, a playground, and several other structures all nestled along a quarter mile long trail loop through native woodland.

Please remember to:

- respect wildlife
- stay on the designated trail

- follow all posted rules
- have fun!

- Restroom
- Drinking Fountain
- Information
- Crosswalk
- Wheelchair Access
- Storm Shelter
- Wheelchair & Stroller Accessible
- Unpaved Path

- 43 Adele & Dean Bowden Treehouse Village (East side entrance)
- 44 Treehouse
- 45 Suspension Bridge
- 46 Treehouse Play Area
- 47 Treehouse Platform
- 48 Treehouse Gazebo
- 49 Treehouse Village Trail

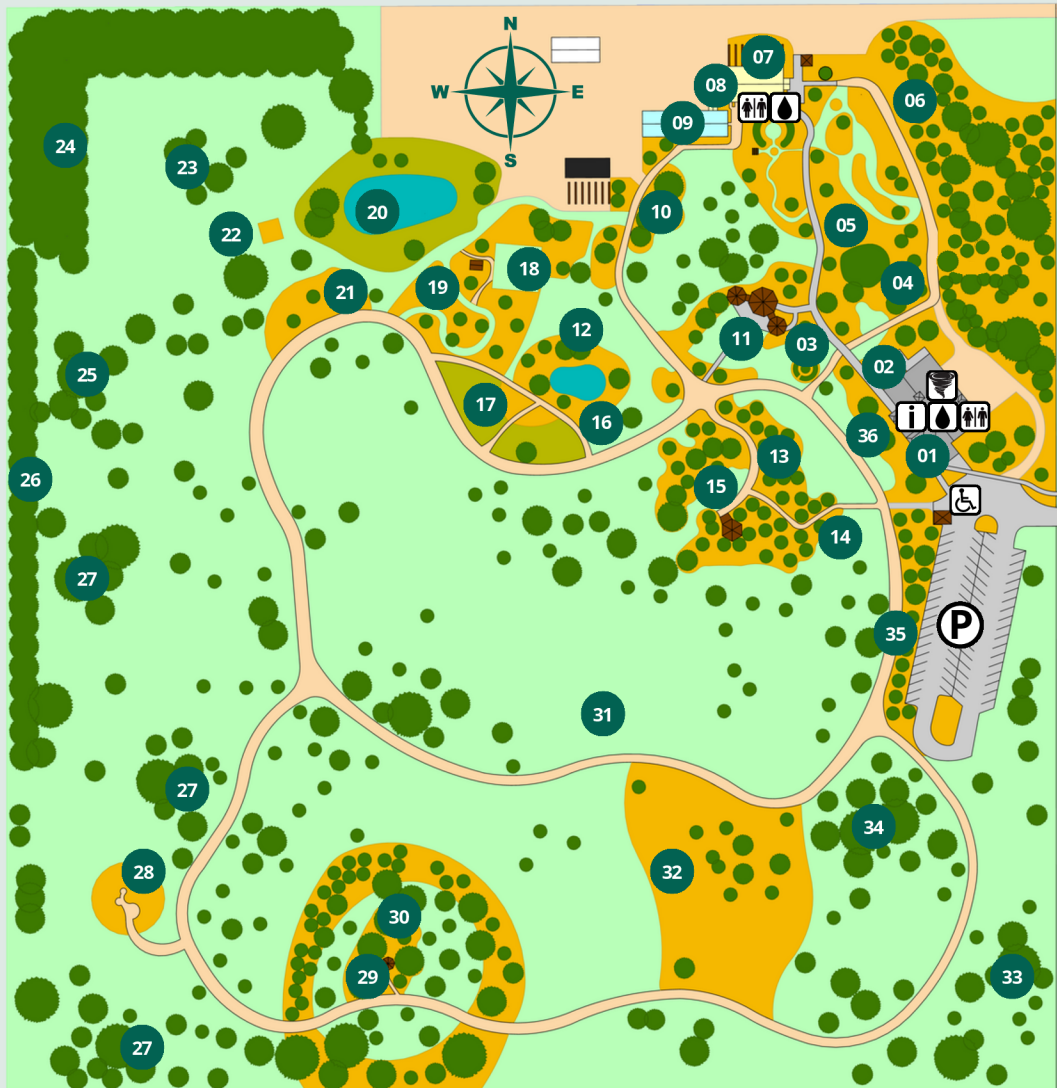

### 37 Prairie Restoration Trail\*

This quiet path follows the woodland edge around our 25 year old 4-acre prairie restoration. Great spot for bird or bug watching. Access from Peach Avenue. .33 miles easy

### 38 North Prairie Loop\* .4 miles easy

### 39 Herrick Memorial Trail\*

Let this out-and-back trail with 133 steps lead you down ravine slopes through native wildflowers and ferns to the Richardson Branch Creek. .25 miles difficult

### 40 Overlook Trail\*

This trail loop sticks to the upland edge through our 60 acre woods. Features scenic views of the wooded Richardson Branch Creek valley below. .5 miles easy

### 41 Walnut Trail\*

This trail loop meanders through level upland woodland. Excellent for viewing birds, butterflies, and summer wildflowers. .75 miles easy

### 42 South Prairie Loops\*

Explore 12 acres of prairie with great bird watching. .75 miles easy

\*trails are not to scale

# VISITOR SERVICES

## ACCESSIBILITY

- Accessible parking spaces located in both parking lots
- Mobility scooters (2) are available for checkout at the front desk
- Accessible indoor and portable restrooms
- Universal height-adjustable changing table
- Automated pedestrian gates
- Wheelchair swing
- Paved, accessible .25 mile woodland trail

## MEMBERS & VOLUNTEERS

Members and volunteers help support one of Iowa's most beautiful resources. To learn more about membership benefits and how to get involved with supporting the arboretum, visit <https://iowaarboretum.org/get-involved/>

## TOURS & FIELD TRIPS

Guided tours and programs are available for groups of all sizes with advance reservation. Contact [groupvisit@iowaarboretum.org](mailto:groupvisit@iowaarboretum.org) or call 515-795-3216 to schedule.

## EDUCATION & PUBLIC EVENTS

Lectures, workshops, and events are offered throughout the year for guests of all ages and abilities. Please visit our website to view our calendar or sign up for our e-newsletter.

## WEDDINGS & FACILITY RENTALS

Our outdoor wedding venues and rental facilities are among the most popular in the region. Indoor rental facilities are available for business meetings and family events.

The Iowa Arboretum, Inc. is a 501(c)3 non-profit organization.

# OUR MISSION

The Iowa Arboretum & Gardens is a community-supported public garden inspiring curiosity, discovery, and appreciation of the natural landscape.

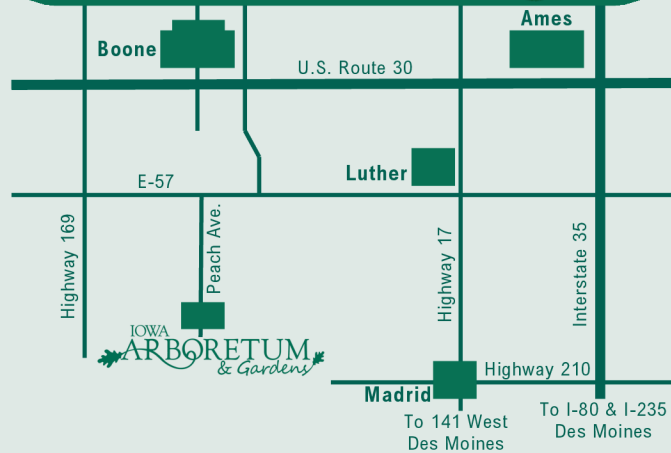

Leashed dogs are permitted on the grounds and in the lobby of the Visitor's Center. Dogs are not allowed in the Children's Garden, Treehouse Playground (mulched area), gift shop, indoor bathrooms, or indoor rental spaces. ADA-certified service dogs are allowed anywhere with proper documentation. All dog owners are responsible for cleaning up and disposing of dog droppings. Dog waste bags are available at stations and front desk.



All Arboretum grounds and trails are smoke free.



Please move to the basement of the Hughes Education Center/Visitor's Center when you hear sirens.

### Treehouse Playground Area

1. Adult supervision required
2. Recommended Ages: 5 to 12 yrs
3. Shoes are required
4. Running, pushing, and shoving are not allowed
5. All slides to be used feet first
6. Food, drinks, or gum on structures are not allowed
7. Be respectful of others
8. And most of all, **Have Fun!**

To learn more about the arboretum, individual collections, and visitor services

visit [www.IowaArboretum.org](http://www.IowaArboretum.org)  
or call 515.795.3216



# VISITOR GUIDE & GROUNDS MAP

Celebrating Trees,  
Gardening, & Wildlife  
Experiences Every Day

1875 Peach Ave. Madrid, IA 50156

515.795.3216

[info@IowaArboretum.org](mailto:info@IowaArboretum.org)

[www.IowaArboretum.org](http://www.IowaArboretum.org)

The gardens, grounds, and Adele & Dean Bowden Treehouse Village are open  
weekdays from 9 am - 4 pm  
weekends from 10 am - 4 pm  
from mid-March to mid-November

The main campus is open from 9 am - 4 pm, Monday - Friday (year-round)