

IOWA ARBORETUM & Gardens

1875 Peach Avenue
Madrid, IA 50156

- 01 Hughes Education Center (West side entrance)
- 02 Iowa Hosta Garden
- 03 Stout Silver Medal Winner Daylily Garden
- 04 Perennial Garden
- 05 Woodland Garden
- 06 Shrub Border
- 07 Theresa Schutt Hosta House
- 08 Cafferty Building
- 09 Dale Seims Greenhouse
- 10 Hosta Border
- 11 Beckwith Grand Pavilion
- 12 Waterside Garden
- 13 Jacobsen Conifer Garden
- 14 Alpine Garden
- 15 Jones Memorial Gazebo
- 16 Butterfly Garden
- 17 Prairie Strip
- 18 Children's Garden
- 19 Orchard and Herb Garden
- 20 Palustrine Wetland
- 21 Iris and Daylily Garden
- 22 Beehive boxes
- 23 Flowering Tree Grove
- 24 Windbreak
- 25 Wetland Tree Grove
- 26 Deciduous Windbreak
- 27 Nut Tree Grove
- 28 Bluestem

- 29 Arie Kroeze Memorial Tea House
- 30 Tea House Garden
- 31 Great Lawn
- 32 Trial Garden
- 33 Founder's Grove
- 34 Governor's Oak Grove
- 35 Coffman Viburnum Walk
- 36 Dry Creek Bed

Adele & Dean Bowden Treehouse Village

Enjoy a collection of treehouses, a playground, and several other structures all nestled along a quarter mile long trail loop through native woodland.

Please remember to:

- respect wildlife
- stay on the designated trail

- follow all posted rules
- have fun!

- Restroom
- Drinking Fountain
- Information
- Crosswalk
- Wheelchair Access
- Storm Shelter
- Wheelchair & Stroller Accessible
- Unpaved Path

- 41 Adele & Dean Bowden Treehouse Village (East side entrance)
- 42 Treehouse
- 43 Suspension Bridge
- 44 Treehouse Playground
- 45 Treehouse Platform
- 46 Treehouse Gazebo
- 47 Treehouse Village Trail

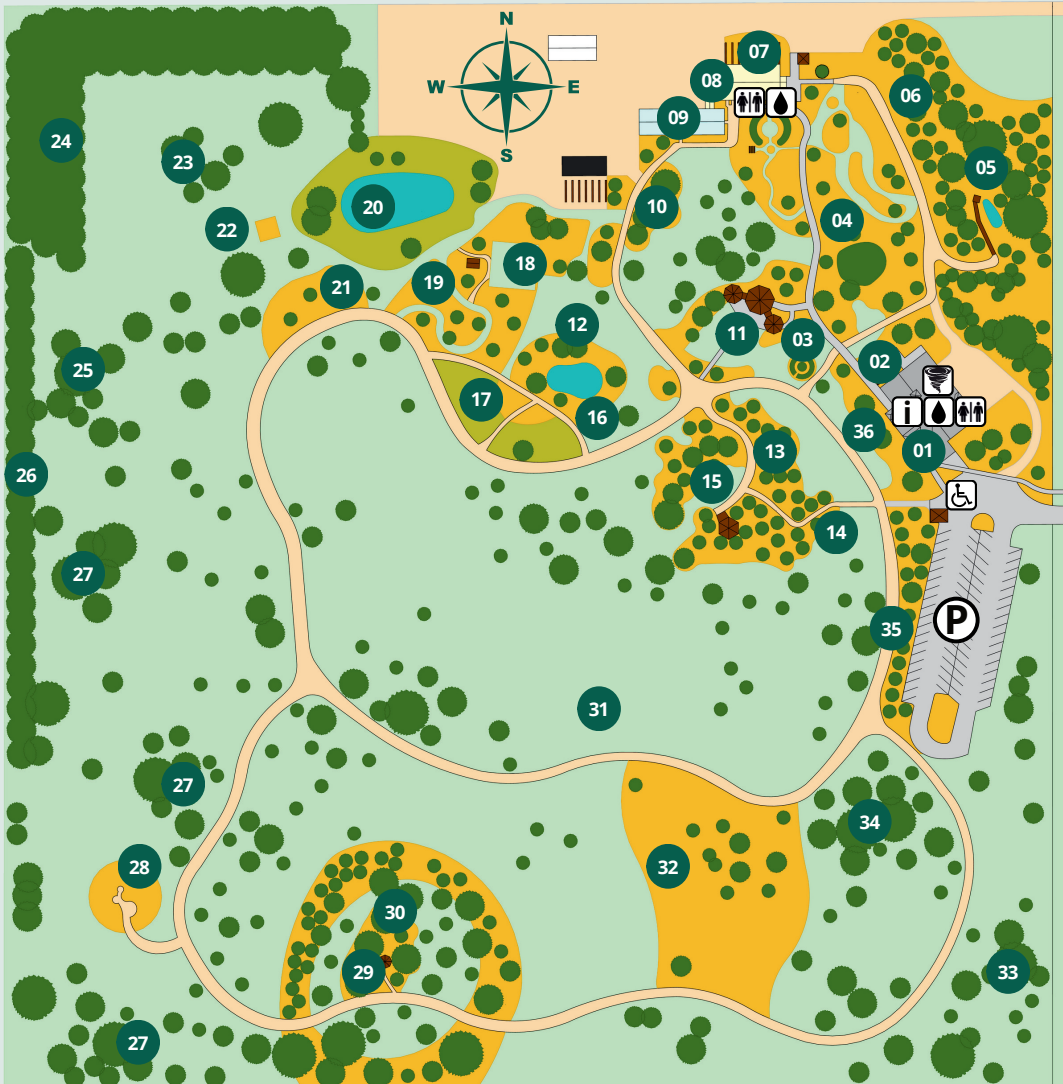

37 Prairie Restoration Trail*

This quiet path follows the woodland edge around our 25 year old 4-acre prairie restoration. Great spot for bird or bug watching. Access from Peach Avenue. .33 miles easy

38 Herrick Memorial Trail*

Let this out-and-back trail with 133 steps lead you down ravine slopes through native wildflowers and ferns to the Richardson Branch Creek. .25 miles difficult

39 Overlook Trail*

This trail loop sticks to the upland edge through our 60 acre woods. Features scenic views of the wooded Richardson Branch Creek valley below. .5 miles easy

40 Walnut Trail*

This trail loop meanders through level upland woodland. Excellent for viewing birds, butterflies, and summer wildflowers. .75 miles easy

*trails are not to scale