

IOWA ARBORETUM

1875 Peach Avenue, Madrid, Iowa 50156

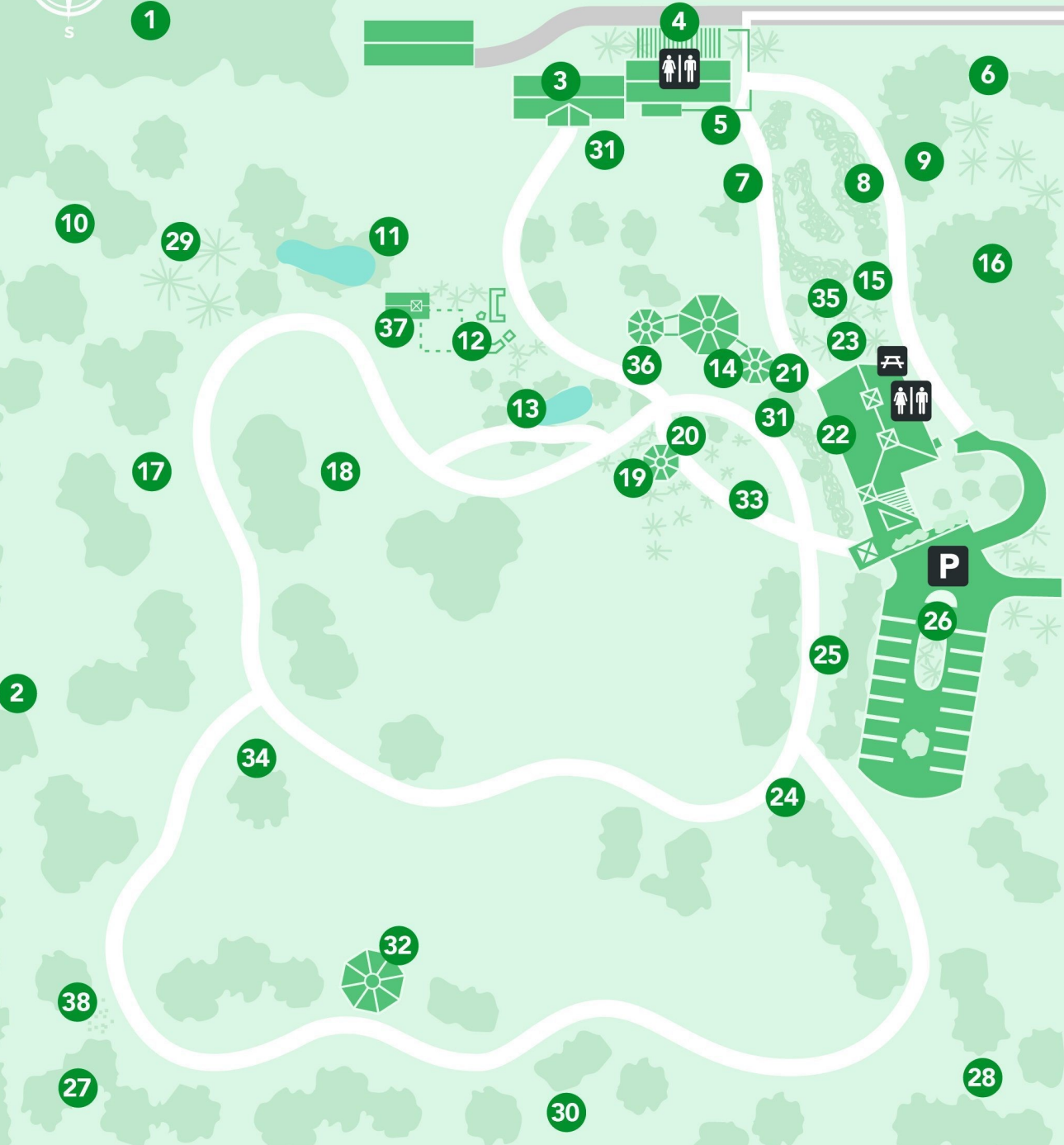

- 1 Windbreak
- 2 Deciduous Windbreak
- 3 Dale Siems Greenhouse
- 4 Hosta Collection
Theresa Schutt Hosta House
- 5 Cafferty Building
- 6 Ornamental Grasses
- 7 Herb Garden
- 8 Perennial Garden
- 9 Shrub Border
- 10 Flowering Trees
- 11 Palustrine Wetland
- 12 Children's Garden & Orchard
- 13 Butterfly Garden
- 14 Beckwith Pavilion
- 15 Conifers
- 16 Shade Garden
- 17 Trees for Poorly
Drained Soil
- 18 Medium Deciduous Trees
- 19 Jones Memorial Gazebo
- 20 Dwarf Conifers
- 21 Sout Dalilies
- 22 Hughes Education Center
- 23 Russ O'Hara
Iowa Collection
- 24 Govenors' Oaks
- 25 Coffman Viburnum Walk
- 26 Parking
- 27 Nut Trees
- 28 Founders Grove
- 29 Beehives
- 30 Columnar Trees
- 31 Iris Collection
- 32 Kroeze Tea House
- 33 Alpine Garden
- 34 Large Deciduous Trees
- 35 Iowa Hostas
- 36 Iowa Breeder Collection
- 37 Iowa School House
- 38 Bluestem



Prairie Trails*

Restored Prairie Trails & Woodland Trails

Cross the road to experience the four-acre restored prairie and hike the self-guided woodland trails. Quiet paths wind beneath a canopy of mature trees on 330 acres, featuring century old oaks, native wildflowers and scenic overlooks. Don't miss the 133 steps leading to the valley of Richardson's Creek on the Herrick Memorial Trail.



Woodland Trails*

- 1 Linden Lane**
.25 mile in length, on level upland.
- 2 Herrick Memorial Trail**
.25 mile in length, including 133 steps leading to valley of Richardson's Creek.
- 3 Overlook Trail**
.25 mile in length, on level upland. Features scenic view of wooded stream valley.
- 4 Walnut Trail**
.5 mile in length, on level upland. Excellent for viewing birds, butterflies, and summer wildflowers.

*Trails are not to scale.